



## The Cooba

Starting from \$16,480\*

Enjoy the natural light which comes flooding through the wide glass frontage of the Cooba. Providing generous views of your garden, or backyard pool, the Cooba makes for a perfect outdoor entertaining area all year round.

Or use it as retreat for your teens. Give them a space to hang out with their friends, while you enjoy a little space of your own.

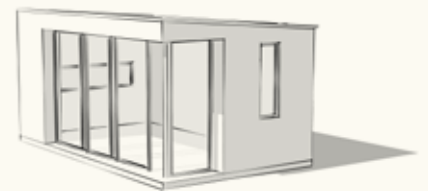
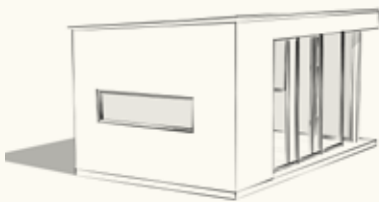

## Standard Inclusions

### Structure

- Steel floor system
- Choice of 3 exterior finishes
  - Colourbond Steel
  - Western Red Cedar (FSC Certified)
  - Dulux Render System\*\*
- Western Red Cedar cladding to front elevation
- Insulated roof panels
- Insulated walls, plaster-boarded and flushed ready for decoration.
- Particle board flooring
- Hardwood front entrance step

### Electrics

- Weatherproof exterior switch board
- Circuit breakers (one extra for optional A/C unit)
- Safety switch
- Separate switching
- Spotlight track & fittings†
- 2 x exterior lights
- Double power points†

### Doors & Windows

- Aluminium door and window frames
- A selection of glass, including double-glazing
- 2 x horizontal awning windows†
- 1 x sliding front door†

† Sizes/numbers vary to suit floor plan.

\* Excludes GST, transportation & installation

\*\*Render exterior available in SA only.

*inoutside*

www.inoutside.com.au

# Cooba Floor Plan Variations

Choose what suits you. All our floor plan designs can be reversed to match in with your existing home and yard.

- D1:** Sliding door
- W1:** Awning desk height horizontal window
- W2:** Awning desk height vertical window
- W3:** Fixed vertical window
- W4:** Fixed vertical window

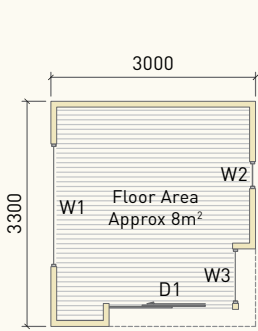

**3x3.3**

- D1: 1810 x 2100
- W1: 1800 x 500
- W2: 400 x 1200
- W3: 800 x 2100

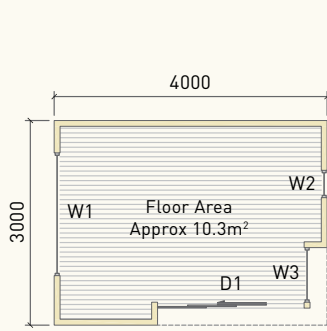

**4x3**

- D1: 2150 x 2100
- W1: 1800 x 500
- W2: 400 x 1200
- W3: 800 x 2100

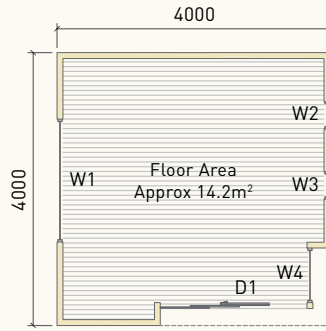

**4x4**

- D1: 2150 x 2100
- W1: 1800 x 500
- W2&3: 400 x 1200 (Awning desk-height vertical window)
- W4: 800 x 2100

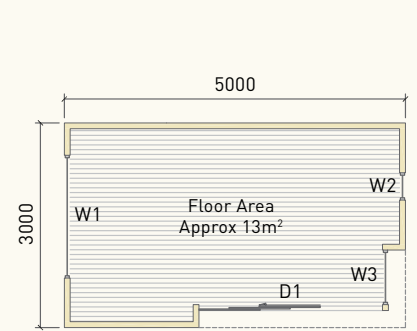

**5x3**

- D1: 2690 x 2100
- W1: 1800 x 500
- W2: 400 x 1200
- W3: 800 x 2100

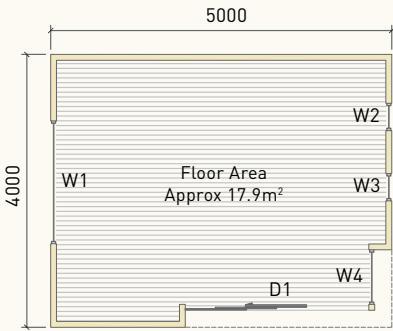

**5x4**

- D1: 2690 x 2100
- W1: 1800 x 500
- W2&3: 400 x 1200 (Awning desk-height vertical window)
- W4: 800 x 2100

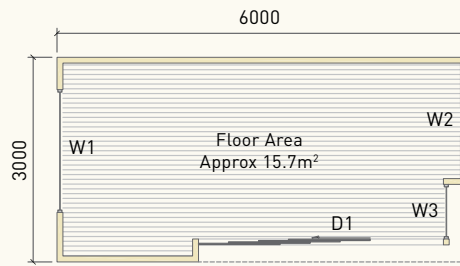

**6x3**

- D1: 3590 x 2100
- W1: 1800 x 500
- W2: 400 x 1200
- W3: 800 x 2100

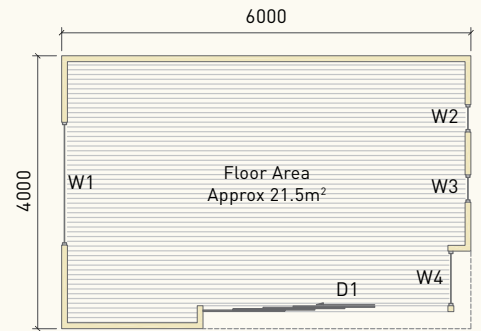

**6x4**

- D1: 3590 x 2100
- W1: 1800 x 500
- W2&3: 400 x 1200 (Awning desk-height vertical window)
- W4: 800 x 2100

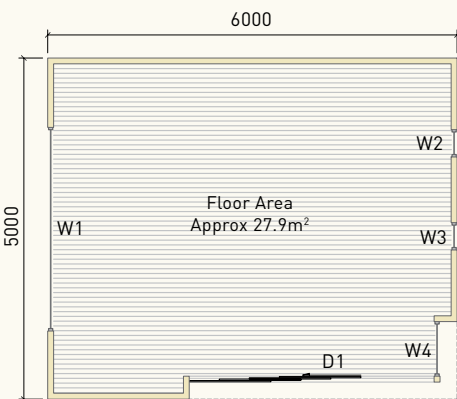

**6x5**

- D1: 3590 x 2100
- W1: 3000 x 500
- W2&3: 400 x 1200 (Awning desk-height vertical window)
- W4: 800 x 2100

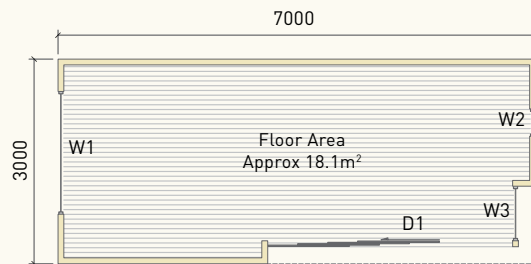

**7x3**

- D1: 3590 x 2100
- W1: 1800 x 500
- W2: 400 x 1200
- W3: 800 x 2100

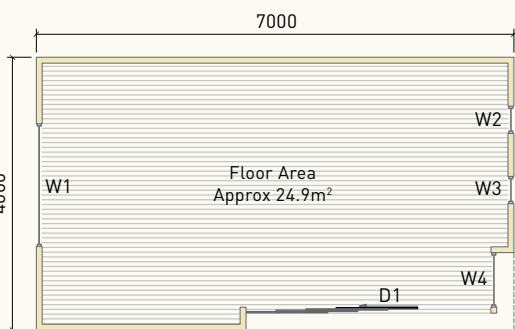

**7x4**

- D1: 3590 x 2100
- W1: 1800 x 500
- W2&3: 400 x 1200 (Awning desk-height vertical window)
- W4: 800 x 2100

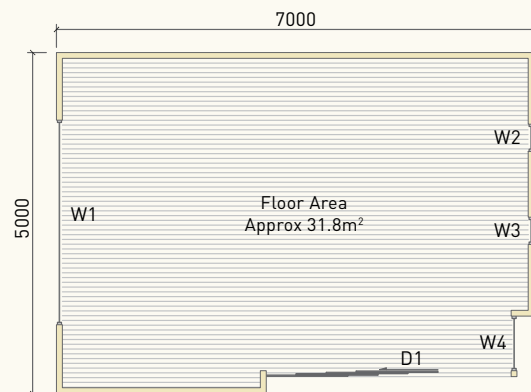

**7x5**

- D1: 3590 x 2100
- W1: 3000 x 500
- W2&3: 400 x 1200 (Awning desk-height vertical window)
- W4: 800 x 2100